



**Commercial Acoustics**  
 5960 W. WASHINGTON STREET  
 PHOENIX, ARIZONA 85043-3523  
 (602) 233-2322 FAX 233-2033

A DIVISION OF METAL FORM MANUFACTURING

# Model MFLA-8AF Fabricated Acoustical Louver 8" Deep Airfoil Blade Regular Pressure Loss

## Specifications

- Frame:** 18ga. galvanized channel frame.
- Blades:** 18ga. galvanized steel / 22ga. galvanized perforated steel.
- Insulation:** 2 lb. density fibreglass.
- Screen:** 1/2" x 1/2" x 19ga. galvanized steel mesh.
- Finish:** Standard mill.
- Minimum size:** 12"w x 18"h.
- Maximum size:** 72"w x 120"h.  
Multiple section - unlimited size.

## Options

- Flanged frame.
- Sill extension.
- Sleeves.
- Sub frame (requires flanged louver).
- Screens - Many variations of screens are available, consult factory.
- Finishes - Many types of finishes are available, consult factory.
- Other options are available, consult factory.

## Notes

1. Width x height are nominal opening dimensions. Unless specified otherwise, units will be constructed 1/4" undersize.
2. Metal Form reserves the right to improve design or change specifications at any time.

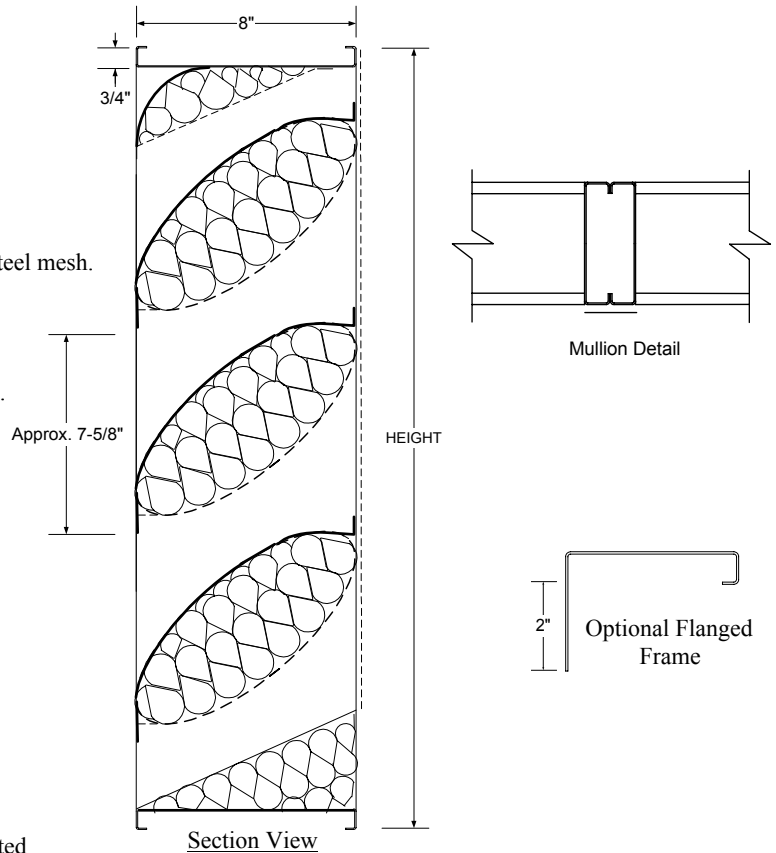

Tag	Qty.	Width	Height	No. of Panels (W x H)	Options	Finishes/Specify	Remarks

**Project:** \_\_\_\_\_  
**Architect:** \_\_\_\_\_  
**Engineer:** \_\_\_\_\_  
**Contractor:** \_\_\_\_\_

©May 2012 Metal Form Manufacturing Co., Inc.  
 Form No. LA-8AF12  
 Supersedes Form No. LA-8AF03

Refer to back page for performance data.

# Model MFLA-8AF Performance Data

**Air Performance**

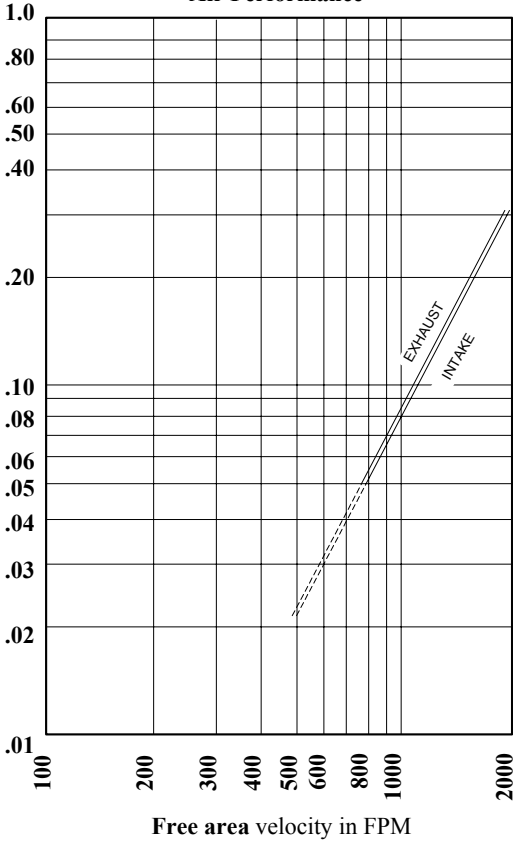

**Acoustical Performance**

Octave Band/Freq. (Hz)	1/63	2/125	3/250	4/500	5/1k	6/2k	7/4k	8/8k
Transmission Loss. db *	6	1	5	7	12	13	10	9
Noise Reduction.db	12	7	11	13	18	19	16	15

\* As measured in accordance with ASTM E 90-02/NVLAP 08/P06

Test unit size 48" x 48"  
 Graphs are corrected to standard air density .075 lbs. per cubic feet.  
 Ratings do not include the effects of a bird screen.

**Free Area Chart - Sq. Ft.**

Height (inches)	120	108	96	84	72	66	60	54	48	42	36	30	24	18	12
120	2.32	3.65	4.98	6.31	7.64	8.97	10.29	11.62	12.95	14.28	15.61				
108	2.01	3.17	4.32	5.47	6.62	7.77	8.92	10.07	11.22	12.37	13.52				
96	1.83	2.88	3.93	4.98	6.03	7.08	8.12	9.17	10.22	11.27	12.32				
84	1.73	2.71	3.70	4.68	5.67	6.65	7.64	8.63	9.61	10.60	11.58				
72	1.27	2.00	2.72	3.45	4.17	4.90	5.63	6.35	7.08	7.80	8.53				
66	1.23	1.93	2.63	3.33	4.04	4.74	5.44	6.14	6.84	7.54	8.25				
60	1.16	1.83	2.50	3.16	3.83	4.49	5.16	5.82	6.49	7.15	7.82				
54	1.08	1.70	2.32	2.94	3.56	4.18	4.79	5.41	6.03	6.65	7.27				
48	0.92	1.45	1.98	2.50	3.03	3.56	4.08	4.61	5.14	5.66	6.19				
42	0.66	1.04	1.42	1.80	2.18	2.56	2.94	3.32	3.70	4.08	4.46				
36	0.60	0.94	1.29	1.63	1.97	2.32	2.66	3.00	3.35	3.69	4.03				
30	0.56	0.88	1.20	1.52	1.83	2.15	2.47	2.79	3.11	3.43	3.75				
24	0.44	0.69	0.94	1.19	1.45	1.70	1.95	2.20	2.45	2.70	2.95				
18	0.28	0.44	0.60	0.76	0.92	1.08	1.24	1.40	1.56	1.71	1.87				
	12	18	24	30	36	42	48	54	60	66	72				

Width (inches)