

# A U D I O M E T R I C T E S T I N G R O O M S



**Commercial Acoustics**  
A DIVISION OF METAL FORM MFG., CO.

# COMMERCIAL ACOUSTICS

contemporary diagnostic testing booths and rooms are specifically



engineered for the assessment needs of audiologists, doctors, researchers, and hearing aid specialists. We combine the latest in modern technology and quality manufacturing for increased patient comfort and accessibility.



■  
*Excellent performance booths and rooms built to satisfy the demanding testing requirements of:*

- Audiologists
- Technicians
- Hearing Aid Evaluation
- Hearing Conservation Programs
- Research Environments
- Universities
- Doctors

*Commercial Acoustics can assure you of standard or customized audiometric booths and rooms that are architecturally attractive, and built with the highest quality workmanship and materials available.*

■

**We** offer a choice of two booths and eight standard audiometric rooms structurally designed for maximum isolation. Custom-sized units are also available to satisfy any space or architectural and audiometric requirements.



## Our standard features include:

<u>Slim line 2" floor with 1/8" steel walking surface</u>
<u>Recessed lighting</u>
<u>16 Gauge outer skin</u>

## Wall and Ceiling

The 4 1/4" thick tongue and groove panel design is made from 16 gauge galvanized outer skin, 16 gauge galvanized roll formed channels and an inner skin of 22 gauge galvanized steel perforated to achieve a 25% open surface for maximum acoustical absorption.

The 16 gauge outer skin is lined with a 1" layer of gypsum board to reduce low frequency, transmission noise. Then it is filled with a 2 pound fiberglass insulation that meets UL fire hazard ratings as per ASTM E-84.

## Floor

The 2" thick floor panels consist of a 1 lb. density fiberglass sandwiched between the 1/8" thick inner skin and 16 gauge outer skin. A 1" layer of gypsum board is also used similar to the walls and ceiling. The thinner floor increased accessibility for wheelchair and handicapped patients.

## Doors

Door construction is similar to that of walls to achieve the same high acoustical performance. The door includes a double magnetic seal gasket, sturdy cam lift hinges and a recessed sill for ease of exiting. Chrome plated door pulls on the interior and exterior of the door facilitates easy entrance and exit.

## Windows

Windows are double glazed with a 1/4" safety glass isolated in an attractive aluminum frame. Standard window size is 24"W x 30"H.

## Wiring & Ventilation

All electrical wiring is concealed within the panel using UL labeled fixtures. The room is equipped with recessed lighting fixtures and hospital grade outlets.

The Commercial Acoustic 1020 & 1021 Booths are furnished with a standard "Jack" panel, consisting of three, 3-pin phone jacks, one each of Cinch Jones 303 & 304 connectors.

The Commercial Acoustic 2000 Series Rooms are furnished with a standard clinical "Jack" panel. The pre-wired panel is supplied with ten, 3-wire phone jacks, two Cinch Jones 303 & 304 plug connectors, two coaxial plugs one, 24-pin parallel port, one,

9-pin serial port and a 1" inch capped pass-through. Other configurations are available upon request. All "Jack" panels are pre-wired and ready to receive the latest audiometric test equipment.

Ventilation is achieved through an intake and discharge silencer designed to allow 1 air change per minute. The entire ventilation system will not generate a noise level in excess of ANSI-SI-1991 standards.

## Finishes

The interior and exterior of the entire unit is coated with a rust inhibitive primer. A 5 mil industrial enamel coating, in our standard off-white color, is applied as a finish coat. Custom colors are available upon request.

Other options include wheelchair ramps, recessed speakers, custom sized windows, door windows, custom wired jack panels, special finishes, upgrade carpet and castors on booth.

## Specifications to meet any requirement:

### BOOTHS

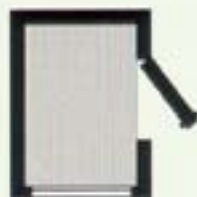

#### CA-1020

	W	D	H
I.D.	24.5"	34.5"	66"
O.D.	29"	39"	79"
I.D.	62CM	88CM	167CM
O.D.	74CM	99CM	201CM



#### CA-1021

	W	D	H
I.D.	24.5"	34.5"	66"
O.D.	29"	39"	79"
I.D.	62CM	88CM	167CM
O.D.	74CM	99CM	201CM

### ROOMS

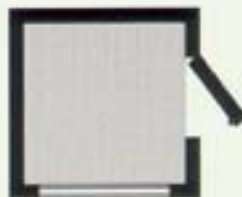

#### CA-2040

	W	D	H
I.D.	30.5"	39.5"	78.5"
O.D.	44"	48"	92"
I.D.	90CM	100CM	199CM
O.D.	112CM	122CM	234CM

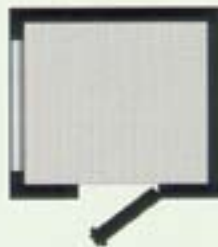

#### CA-2041

	W	D	H
I.D.	47.5"	39.5"	78.5"
O.D.	56"	48"	92"
I.D.	121CM	100CM	199CM
O.D.	142CM	122CM	234CM

#### CA-2046

	W	D	H
I.D.	61.5"	47.5"	78.75"
O.D.	70"	56"	89"
I.D.	156CM	121CM	200CM
O.D.	178CM	142CM	226CM

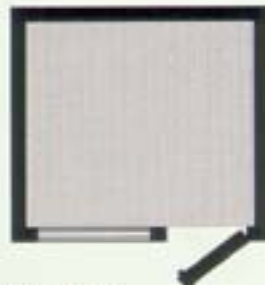

#### CA-2042

	W	D	H
I.D.	75.5"	71.5"	78.75"
O.D.	84"	80"	89"
I.D.	192CM	182CM	200CM
O.D.	213CM	203CM	226CM

#### CA-2043

	W	D	H
I.D.	57.5"	86.5"	78.75"
O.D.	96"	92"	89"
I.D.	222CM	220CM	200CM
O.D.	244CM	234CM	226CM

#### CA-2044

	W	D	H
I.D.	107.5"	99.5"	78.75"
O.D.	116"	108"	89"
I.D.	273CM	253CM	200CM
O.D.	295CM	274CM	226CM

#### CA-2045

	W	D	H
I.D.	119.5"	111.5"	78.75"
O.D.	128"	120"	89"
I.D.	304CM	283CM	200CM
O.D.	325CM	305CM	226CM

#### CA-2047

	W	D	H
I.D.	95.5"	61.5"	78.75"
O.D.	104"	70"	89"
I.D.	243CM	156CM	200CM
O.D.	264CM	178CM	226CM

# Commercial Acoustics

...has 25 years proven performance in manufacturing products and systems for HVAC, security, and sound reduction applications. Products are distributed worldwide from our new 84,000 square foot fully automated plant in Phoenix, Arizona.



**As an industry leader,** our reputation for commitment, innovations and quality design at affordable prices is unsurpassed. Our company is dedicated to efficiency and customer satisfaction. We demand and achieve excellence.

We have more than 75 representative organizations located in major cities throughout the United States, Canada, Mexico and the Pacific Rim.



5690 WEST WASHINGTON STREET, PHOENIX, ARIZONA 85043  
(602) 233-2322 • FAX: (602) 233-2033

*Contact your area representative for additional information.*