

# Acoustical Louver



Commercial Acoustics

5960 W. WASHINGTON ST.  
PHOENIX, ARIZONA 85043-3523  
(602) 233-2322 FAX 233-2033

A DIVISION OF METAL FORM MANUFACTURING

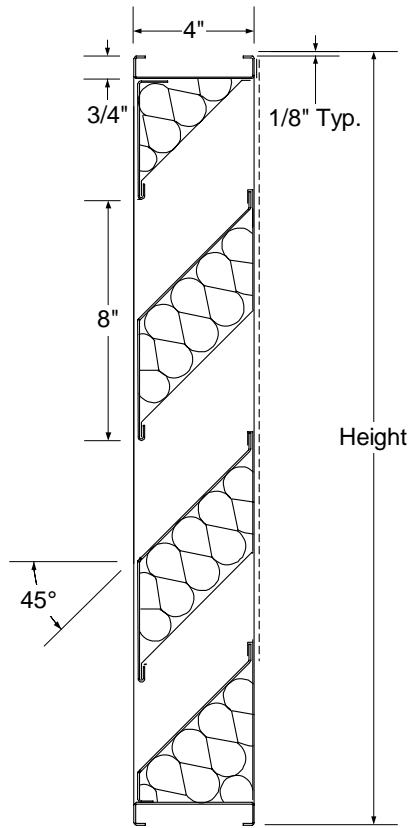

## MFLA-4-36

Fabricated  
45° Blade, 4" DEPTH

### SPECIFICATIONS

**FRAME:** 16 gauge galvanized steel channel  
**BLADES:** 16 gauge galvanized steel  
**BLADE SPACING:** 4" standard  
**FINISH:** Mill finish standard

### SIZES

**MINIMUM:** 24" x 24"  
**MAXIMUM:** Louvers larger than 96" high x 72" are made in sections with mullions, making size unlimited.  
**DEPTH:** 4" frame standard

### OPTIONS

**SCREEN:** 1/2" x 1/2" 19 gauge galvanized mesh. Other size and material screens available.  
**FLANGE FRAME:** 2" flange standard. Other sizes available.  
**MATERIAL:** Aluminum, Stainless Steel, and heavier gauge galvanized steels available.  
**FINISH:** Painted  
A. Prime coat  
B. Color coat (see color chart)

PROJECT: \_\_\_\_\_

LOCATION: \_\_\_\_\_

ENGINEER: \_\_\_\_\_

CONTRACTOR: \_\_\_\_\_

REVISIONS: \_\_\_\_\_

### ACOUSTIC PERFORMANCE

OCTAVE BAND	1	2	3	4	5	6	7	8
CENTER FREQUENCY. Hz	63	125	250	500	1K	2K	4K	8K
TL. dB	5	4	5	7	8	12	13	14
NR. dB	11	10	10	11	14	18	21	20

### AERODYNAMIC PERFORMANCE

PRESSURE LOSS, iwg	.05	.15	.20	.35	.45	.60	.75	1.0
FACE VELOCITY, fpm	200	346	400	529	600	693	775	895

NOTE: Louver will be supplied 1/4 inch smaller than width and height dimensions shown below.

QUANTITY	WALL OPENING		NO. OF SECTIONS	SILL TYPE	FINISH	REMARKS AND OPTIONS
	WIDTH	HEIGHT				