

# Acoustical Louver



Commercial Acoustics

5960 W. WASHINGTON ST.  
PHOENIX, ARIZONA 85043-3523  
(602) 233-2322 FAX 233-2033

A DIVISION OF METAL FORM MANUFACTURING

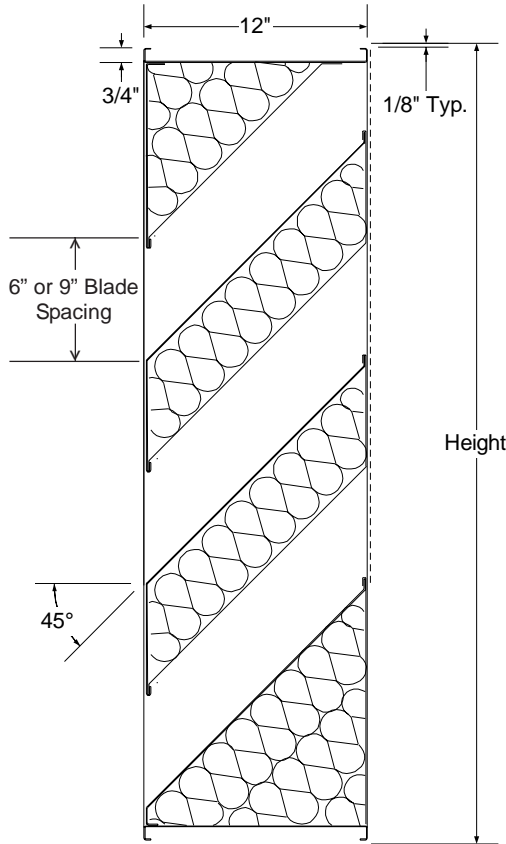

## MFLA-12-36

Fabricated  
45° Blade, 12" DEPTH

### SPECIFICATIONS

**FRAME:** 16 gauge galvanized steel channel  
**BLADES:** 16 gauge galvanized steel  
**BLADE SPACING:** 6" or 9" standard  
**FINISH:** Mill finish standard

### SIZES

**MINIMUM:** 24" x 24"  
**MAXIMUM:** Louvers larger than 96" high x 72" wide are made in sections with mullions, making size unlimited.  
**DEPTH:** 12" frame standard

### OPTIONS

**SCREEN:** 1/2" x 1/2" 19 gauge galvanized mesh. Other size and material screens available.  
**FLANGE FRAME:** 2" flange standard. Other sizes available.  
**MATERIAL:** Aluminum, Stainless Steel, and heavier gauge galvanized steels available.  
**FINISH:** Painted  
A. Prime coat  
B. Color coat (see color chart)

PROJECT: \_\_\_\_\_

LOCATION: \_\_\_\_\_

ENGINEER: \_\_\_\_\_

CONTRACTOR: \_\_\_\_\_

REVISIONS: \_\_\_\_\_

### ACOUSTIC PERFORMANCE

OCTAVE BAND	1	2	3	4	5	6	7	8
CENTER FREQUENCY. Hz	63	125	250	500	1K	2K	4K	8K
TL. dB 6"	3	7	9	11	16	18	12	10
TL. dB 9"	3	6	7	9	14	13	11	10
NR. dB 6"	11	13	15	17	22	24	20	15
NR. dB 9"	9	12	14	17	20	18	17	15

### AERODYNAMIC PERFORMANCE

PRESSURE LOSS, iwg	.05	.15	.20	.35	.45	.60	.75	1.0
FACE VELOCITY, fpm 6"	200	346	385	517	571	675	750	829
FACE VELOCITY, fpm 9"	250	429	500	650	746	850	965	1122

NOTE: Louver will be supplied 1/4 inch smaller than width and height dimensions shown below.

QUANTITY	WALL OPENING		NO. OF SECTIONS	SILL TYPE	FINISH	REMARKS AND OPTIONS
	WIDTH	HEIGHT				